

DY Tassello con dadino conico assemblato con rondella e accessori, in acciaio zincato

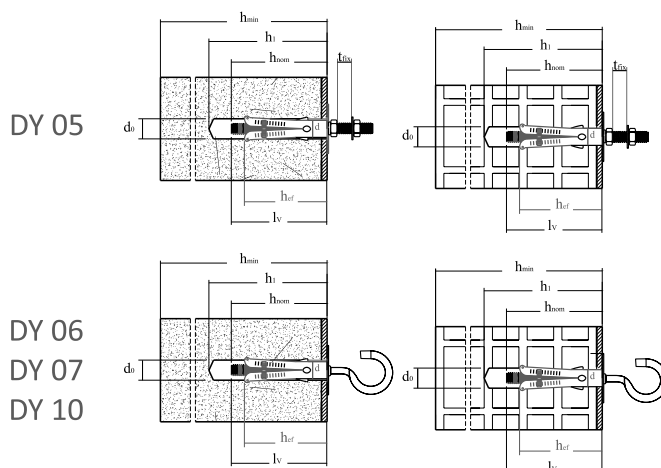

SCHEDA TECNICA

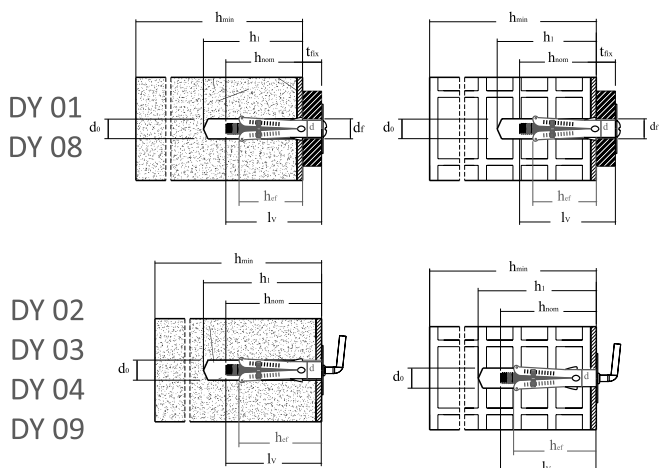

d_{nom}	diametro tassello
l_t	lunghezza tassello
M	diametro del filetto metrico
l_v	lunghezza vite
t_{fix}	massimo spessore fissabile
d_0	diametro del foro
h_1	profondità del foro

h_{min}	spessore del materiale di supporto
h_{nom}	profondità di inserimento
h_{ef}	effettiva profondità di ancoraggio
d_f	diametro del foro nell'elemento da fissare
c_{min}	minima distanza dal bordo consentita
s_{min}	minimo interasse consentito

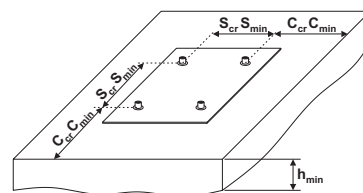

Sequenza di installazione su materiali compatti* di DY 01

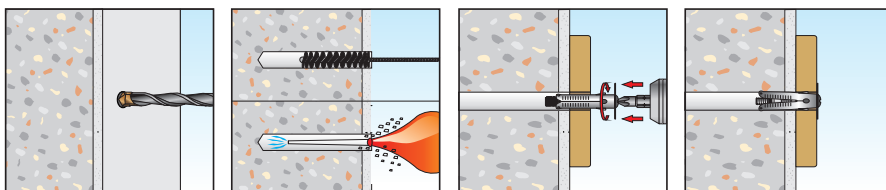

* Nei materiali compatti eseguire il foro con la modalità di rotopercussione

Sequenza di installazione su materiali semipieni* di DY 01

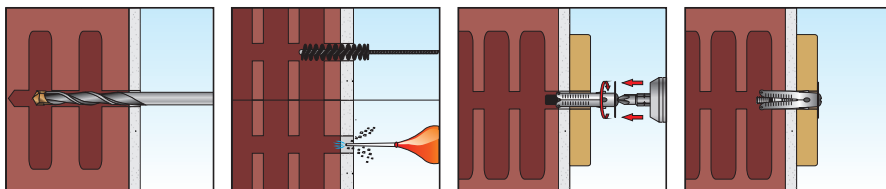

* Nei materiali semipieni eseguire il foro con la sola modalità di rotazione

Sequenza di installazione su materiali forati* di DY 01

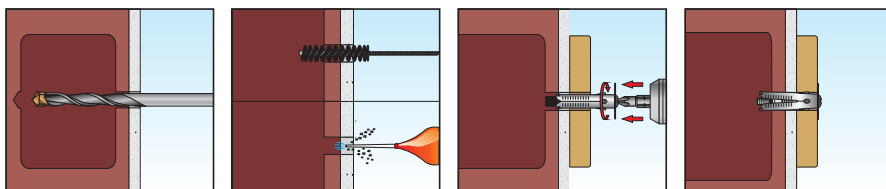

* Nei materiali forati eseguire il foro con la sola modalità di rotazione

DY Tassello con dadino conico assemblato con rondella e accessori, in acciaio zincato



SCHEDA TECNICA

DATI DI INSTALLAZIONE ANCORANTE TECFI DY CON VITE

Codice Articolo	Misura Tassello $d_{nom} \times l_t$ (mm)	Misura Vite $M \times l_v$ (mm)	$t_{fix\ max}$ (mm)	d_o (mm)	h_1 (mm)	h_{min} (mm)	h_{nom} (mm)	h_{ef} (mm)	d_f (mm)	c_{min} (mm)	s_{min} (mm)
DY 01 08 035	8 x 35	M4 x 50	5	8	40	50	30	25	10	50	50
DY 01 09 040	9 x 40	M5 x 55	5	9	45	60	35	30	12	60	60
DY 05 08 035	8 x 35	M4 x 43	5	8	40	50	30	25	10	50	50
DY 05 09 040	9 x 40	M5 x 48	5	9	45	60	35	30	12	60	60
DY 08 09 050	9 x 50	M5 x 65	10	9	50	70	40	35	12	70	70

DATI DI INSTALLAZIONE ANCORANTE TECFI AY CON GANCIO O OCCHIOLO

Codice Articolo	Misura Tassello $d_{nom} \times l_t$ (mm)	Misura Vite $M \times l_v$ (mm)	d_o (mm)	h_1 (mm)	h_{min} (mm)	h_{nom} (mm)	h_{ef} (mm)	c_{min} (mm)	s_{min} (mm)
DY 02 08 035	8 x 35	M4 x 43	8	45	50	35	30	50	50
DY 02 09 040	9 x 40	M5 x 48	9	50	60	40	35	60	60
DY 03 08 035	8 x 35	M4 x 43	8	45	50	35	30	50	50
DY 03 09 040	9 x 40	M5 x 48	9	50	60	40	35	60	60
DY 04 08 035	8 x 35	M4 x 43	8	45	50	35	30	50	50
DY 04 09 040	9 x 40	M5 x 48	9	50	60	40	35	60	60
DY 06 08 035	8 x 35	M4 x 43	8	45	50	35	30	50	50
DY 06 09 040	9 x 40	M5 x 48	9	50	60	40	35	60	60
DY 07 08 035	8 x 35	M4 x 43	8	45	50	35	30	50	50
DY 07 09 040	9 x 40	M5 x 48	9	50	60	40	35	60	60
DY 09 09 050	9 x 50	M5 x 65	9	60	9	50	45	90	90
DY 10 09 050	9 x 50	M5 x 65	9	60	9	50	45	90	90

CARICHI CONSIGLIATI (KG)

Codice Articolo	CALCESTRUZZO $\geq C20/25$	MURATURA FORATA	MURATURA PIENA	CALCESTRUZZO AERATO AUTOCLAVATO	TUFO
DY 01 08 035	30	10	20	10	10
DY 01 09 040	50	20	40	20	20
DY 02 08 035	7	7	7	7	7
DY 02 09 040	15	15	15	15	15
DY 03 08 035	7	7	7	7	7
DY 03 09 040	15	15	15	15	15
DY 04 08 035	7	7	7	7	7
DY 04 09 040	15	15	15	15	15
DY 05 08 035	30	10	20	10	10
DY 05 09 040	50	20	40	20	20
DY 06 08 035	7	7	7	7	7
DY 06 09 040	15	15	15	15	15
DY 07 08 035	7	7	7	7	7
DY 07 09 040	15	15	15	15	15
DY 08 09 050	60	35	60	15	25
DY 09 09 050	15	15	15	15	15
DY 10 09 050	15	15	15	15	15

DY Zinc plated steel anchors with M4/M5 accessories, steel washer and conical nut



TECHNICAL DATA SHEET

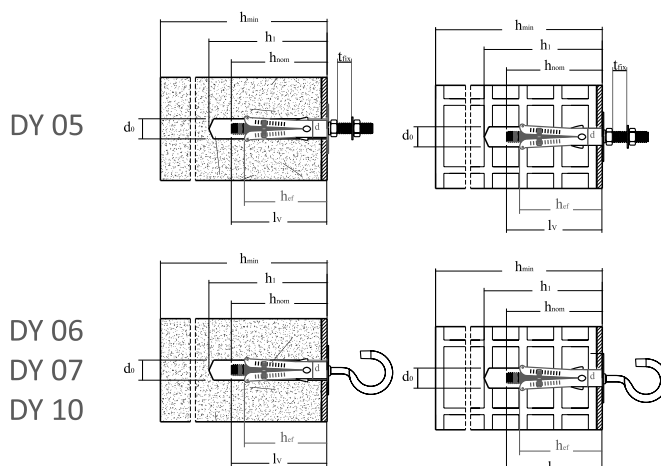
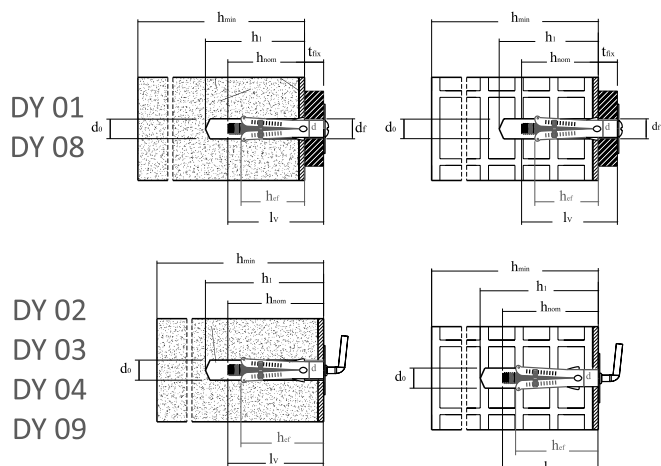

d_{nom}	anchor diameter
l_t	anchor length
M	screw diameter
l_v	screw length
t_{fix}	maximum thickness of fixture
d_0	drill hole diameter
h_1	depth of drill hole

h_{min}	minimum thickness of the member
h_{nom}	overall anchor embedment depth
h_{ef}	effective anchorage depth
d_f	diameter of clearance hole in the fixture
c_{min}	minimum allowable edge distance
s_{min}	minimum allowable spacing

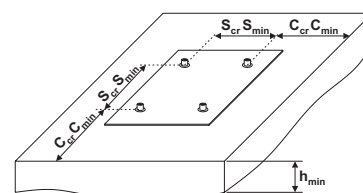

DY 01 - Installation sequence in concrete and solid masonry*

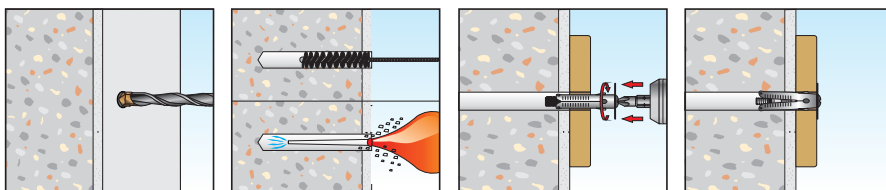

* In the concrete and solid masonry make the drill hole by hammer drilling

DY 01 - Installation sequence in perforated masonry*

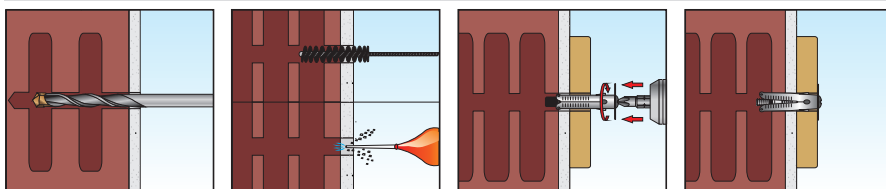

* In the perforated masonry make the drill hole with rotary drilling only

DY 01 - Installation sequence in hollow masonry*

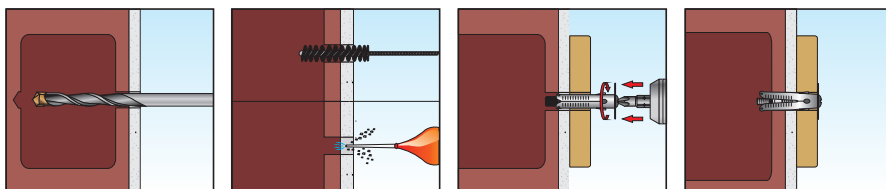

* In the hollow masonry make the drill hole with rotary drilling only

DY Zinc plated steel anchors with M4/M5 accessories, steel washer and conical nut



TECHNICAL DATA SHEET

TECHNICAL DATA AND TEST REPORT OF DY01 - DY05 - DY08

Item Code	Anchor Size $d_{nom} \times l_t$ (mm)	Screw Size $M \times l_v$ (mm)	$t_{fix\ max}$ (mm)	d_o (mm)	h_1 (mm)	h_{min} (mm)	h_{nom} (mm)	h_{ef} (mm)	d_f (mm)	c_{min} (mm)	s_{min} (mm)
DY 01 08 035	8 x 35	M4 x 50	5	8	40	50	30	25	10	50	50
DY 01 09 040	9 x 40	M5 x 55	5	9	45	60	35	30	12	60	60
DY 05 08 035	8 x 35	M4 x 43	5	8	40	50	30	25	10	50	50
DY 05 09 040	9 x 40	M5 x 48	5	9	45	60	35	30	12	60	60
DY 08 09 050	9 x 50	M5 x 65	10	9	50	70	40	35	12	70	70

TECHNICAL DATA AND TEST REPORT OF DY02 - DY03 - DY04 - DY06 - DY07 - DY09 - DY10

Item Code	Anchor Size $d_{nom} \times l_t$ (mm)	Screw Size $M \times l_v$ (mm)	d_o (mm)	h_1 (mm)	h_{min} (mm)	h_{nom} (mm)	h_{ef} (mm)	c_{min} (mm)	s_{min} (mm)
DY 02 08 035	8 x 35	M4 x 43	8	45	50	35	30	50	50
DY 02 09 040	9 x 40	M5 x 48	9	50	60	40	35	60	60
DY 03 08 035	8 x 35	M4 x 43	8	45	50	35	30	50	50
DY 03 09 040	9 x 40	M5 x 48	9	50	60	40	35	60	60
DY 04 08 035	8 x 35	M4 x 43	8	45	50	35	30	50	50
DY 04 09 040	9 x 40	M5 x 48	9	50	60	40	35	60	60
DY 06 08 035	8 x 35	M4 x 43	8	45	50	35	30	50	50
DY 06 09 040	9 x 40	M5 x 48	9	50	60	40	35	60	60
DY 07 08 035	8 x 35	M4 x 43	8	45	50	35	30	50	50
DY 07 09 040	9 x 40	M5 x 48	9	50	60	40	35	60	60
DY 09 09 050	9 x 50	M5 x 65	9	60	9	50	45	90	90
DY 10 09 050	9 x 50	M5 x 65	9	60	9	50	45	90	90

CARICHI CONSIGLIATI (KG)

Item Code	CONCRETE $\geq C20/25$	PERFORATED MASONRY	SOLID MASONRY	AERATED AUTOCLAVATED CONCRETE	TUFF
DY 01 08 035	30	10	20	10	10
DY 01 09 040	50	20	40	20	20
DY 02 08 035	7	7	7	7	7
DY 02 09 040	15	15	15	15	15
DY 03 08 035	7	7	7	7	7
DY 03 09 040	15	15	15	15	15
DY 04 08 035	7	7	7	7	7
DY 04 09 040	15	15	15	15	15
DY 05 08 035	30	10	20	10	10
DY 05 09 040	50	20	40	20	20
DY 06 08 035	7	7	7	7	7
DY 06 09 040	15	15	15	15	15
DY 07 08 035	7	7	7	7	7
DY 07 09 040	15	15	15	15	15
DY 08 09 050	60	35	60	15	25
DY 09 09 050	15	15	15	15	15
DY 10 09 050	15	15	15	15	15